

5SMP2 – D66 – 1 – R 00 – A

① ② ③ ④ ⑤ ⑥

① **5SMP2 系列**：適用低轉速節能定量葉片泵
5：5" 安裝， SMP：節能使用泵

② **Cam ring for "P1" (P1 流量)**

Volumetric displacement (cm³/rev)

66=66.0 113=113.4
81=81.1 120=120.6
90=89.9 137=137.5
99=99.1

③ **Type of Shaft (心軸種類)**

- 1、 Keyed (Ø31.75 key7.94)
- 2、 Keyed (Ø34.9 key7.94)

④ **Rotation (轉向，面對心軸)**

- R： Clockwise (正)
- L： Anti-Clockwise(反)

⑤ **Porting combination**

00 = standard

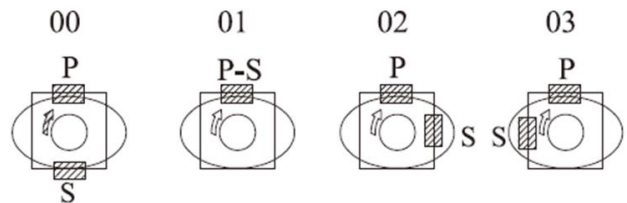

S=Suction port P=Pressure port

⑥ **Design letter**

5SMP2 Dimensional Drawing

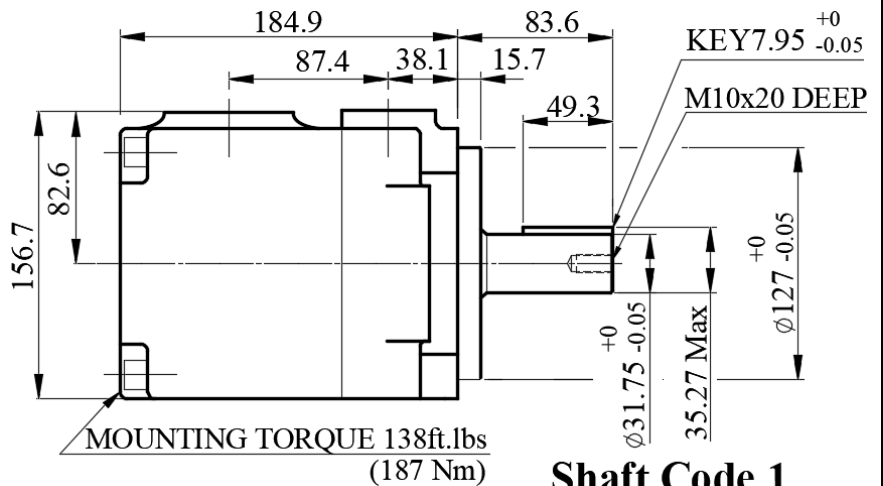
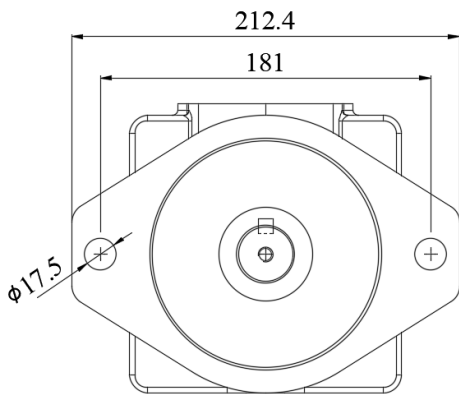

Shaft Code 1

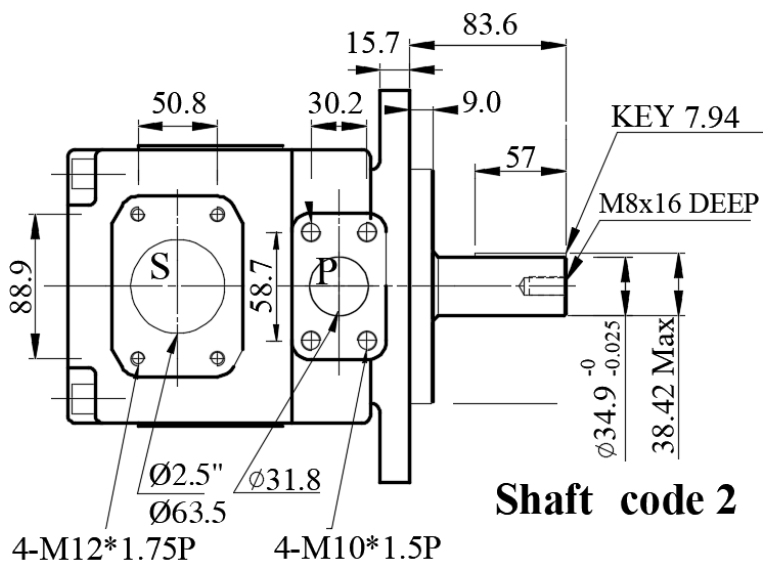

Shaft code 2

| 心軸扭力限制 (mL/rev x bar) | | |
|----------------------------|-------|------------|
| Pump | Shaft | Vp x P max |
| 5SMP2 | 1 | 43283 |
| | 2 | 51684 |

INTERNAL LEAKAGE (TYPICAL)

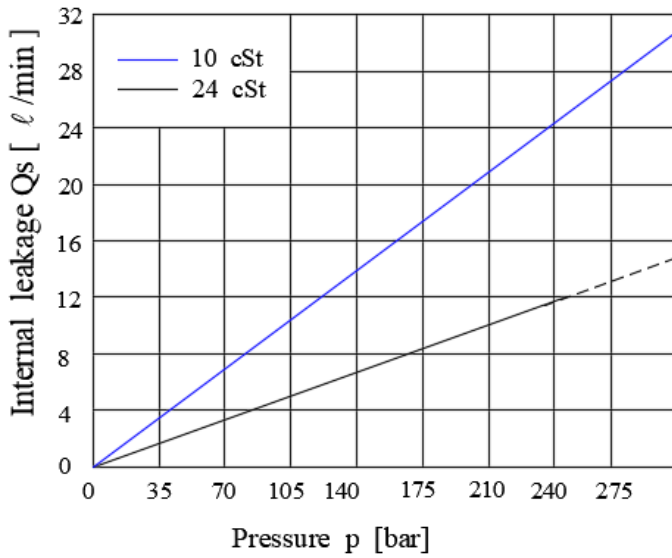

HYDROMECHANICAL POWER LOSS (TYPICAL)

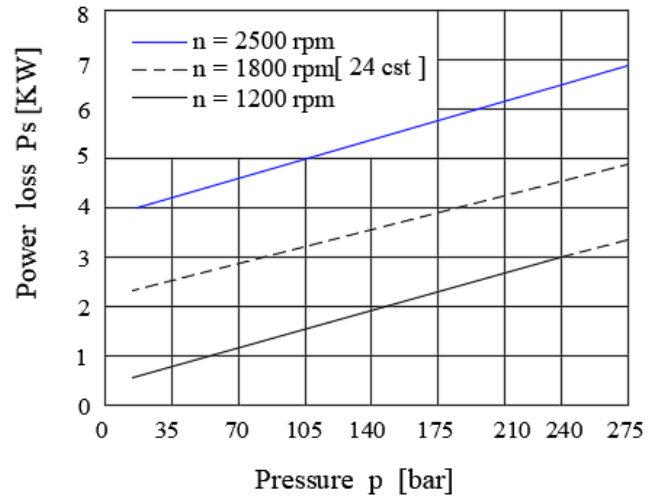

PERMISSIBLE RADIAL LOAD

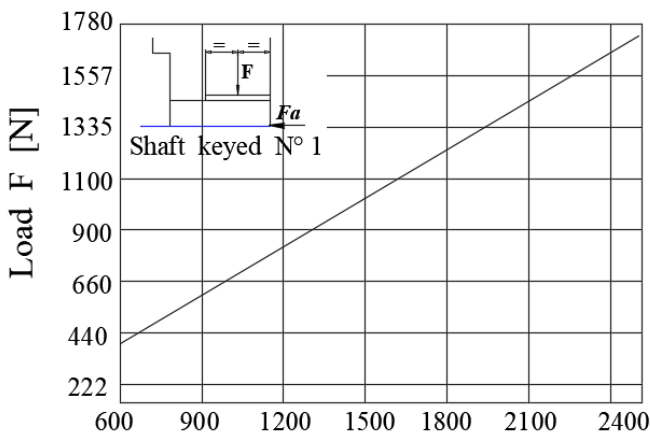

| RPM | Oil Temperature | Oil Viscosity | Remark |
|------|-----------------|---------------|------------|
| 1800 | 40 | VG32 | 泵重 28.2 Kg |

| Model | 流量 | 0 Bar | 140 Bar | 240 Bar | P Max Bar (10 秒) | Max RPM |
|-------|----------|-------|---------|---------|------------------|---------|
| 66 | 66.0 cc | 118.6 | 112.0 | 105.4 | 300 | 3000 |
| 81 | 81.1 cc | 145.8 | 139.2 | 126.0 | | |
| 90 | 89.9 cc | 161.8 | 155.2 | 142.0 | | |
| 99 | 99.1 cc | 178.3 | 171.7 | 158.5 | | |
| 113 | 113.4 cc | 203.9 | 197.2 | 184.0 | 280 | |
| 120 | 120.6 cc | 216.8 | 210.2 | 197.0 | 260 | |
| 137 | 137.5 cc | 247.2 | 240.6 | 235.8 | | |