

**4SMP - B22 - 1 - R 00 - A**

- ① ② ③ ④ ⑤ ⑥

① **4SMP 系列：適用低轉速節能定量葉片泵**  
**4：4" 安裝，SMP：節能使用泵**

② **Cam ring for "P1" ( P1 流量 )**

Volumetric displacement (cm<sup>3</sup>/rev)

- B16=159      B32=31.8
- B22=22.5    B41=40.9
- B25=24.9    B45=45.1
- B28=28.0    B50=50.0

③ **Type of Shaft (心軸種類)**

- 1、Keyed ( Ø22.225 key38.1 )
- 2、Keyed ( Ø25.060 key39.8 )
- 3、Splined ( 13 teeth )
- 5、Keyed ( Ø25.400 key31.8 )

④ **Rotation (轉向，面對心軸)**

R : Clockwise (正)

L : Anti-Clockwise(反)

⑤ **Porting combination ( 油口方向 )**

00 = standard

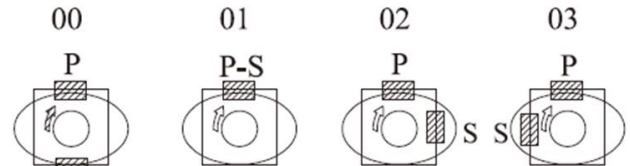

**S=Suction port**

**P=Pressure port**

⑥ **Design letter**

**4SMP Dimensional Drawing**

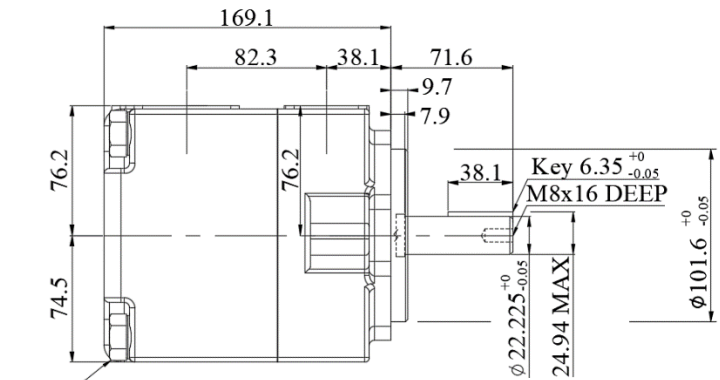
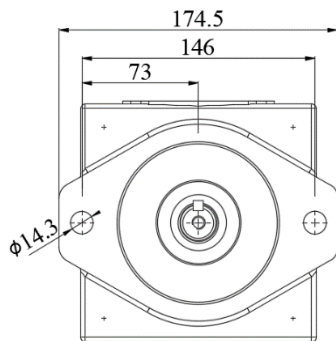

**MOUNTING TORQUE 180 Nm Shaft code 1**

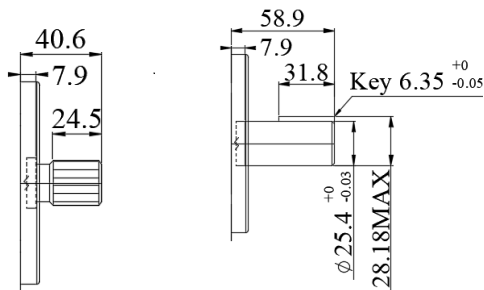

**Shaft code 3**

**Shaft code 5**

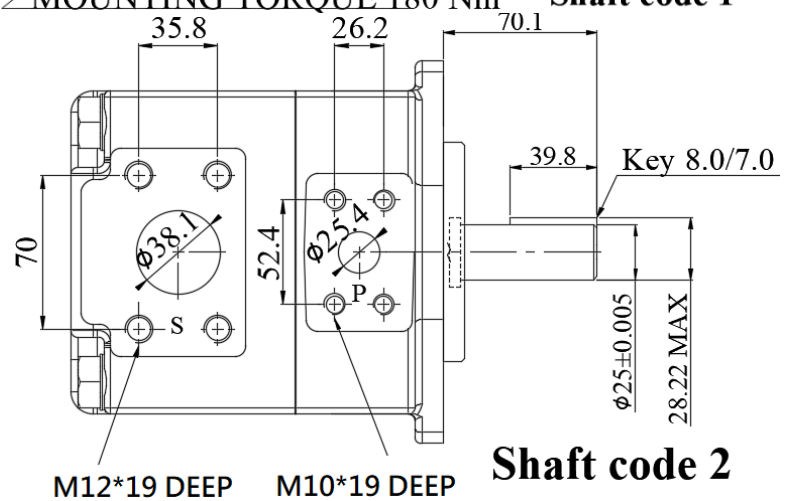

**Shaft code 2**

**SAE B**

**Splined Shaft**

Class 1-J498 b

16/32 dp.-13 teeth

30° Pressure angle.

Flat root side fit.

心軸扭力限制 ( mL/rev x bar )	
Shaft	Vp x P max
1	16516
2	20620
3	20620
5	20620

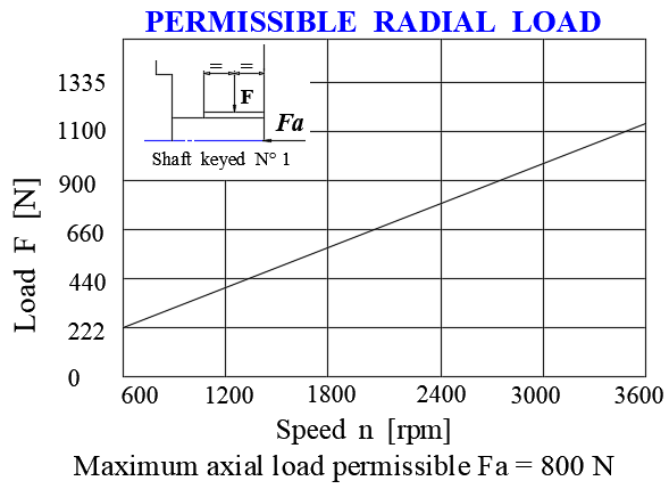
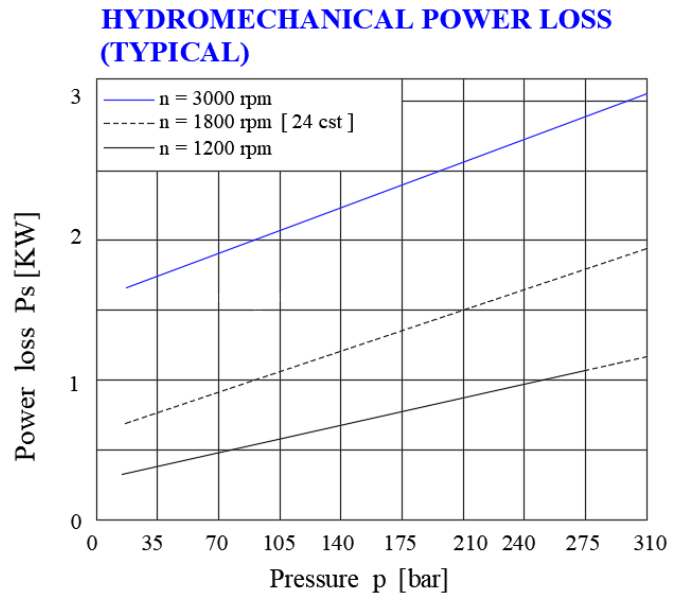
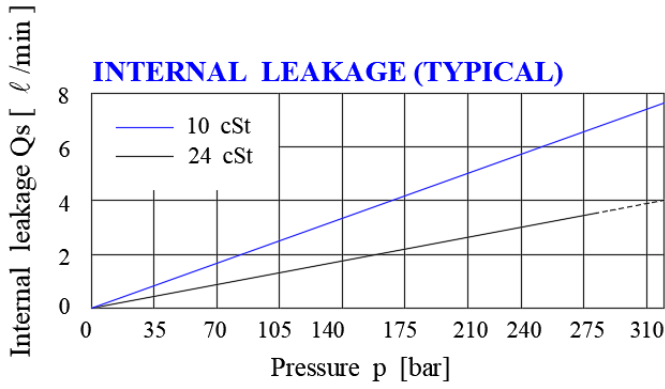

RPM	Oil Temperature	Oil Viscosity	Remark
1800	40	VG32	泵重 23.5 Kg

Model	流量	0 Bar	140 Bar	290 Bar	P Max Bar (10 秒)	Max RPM
16	15.9 cc	28.6	26.9	25.1	320	3000
22	22.5 cc	40.4	38.8	37.1	320	
25	24.9 cc	44.7	43.1	41.3	320	
28	28.0 cc	50.3	48.6	46.8	320	
32	31.8 cc	57.2	55.5	53.7	320	
41	40.9 cc	73.7	72.1	70.4	300	
45	45.1 cc	80.8	79.3	77.7	300	
50	50.0 cc	89.8	88.3	86.7	280	